

UCS: WRLD
 MS VIEW: 1000.E3
 LUMIN: ELEC-WELLZONE
 CTR: F&O Standard

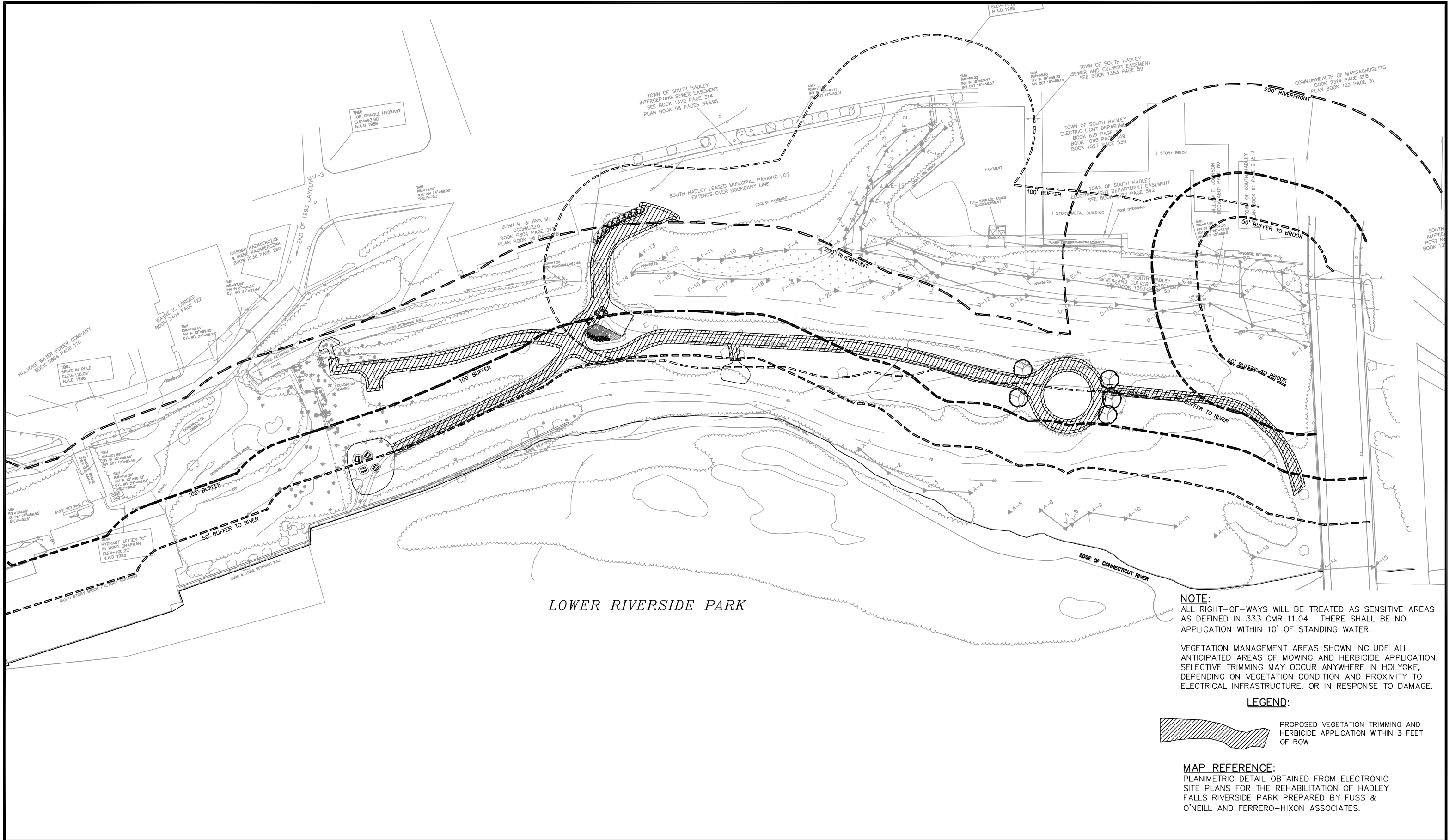

LOWER RIVERSIDE PARK

NOTE:
 ALL RIGHT-OF-WAYS WILL BE TREATED AS SENSITIVE AREAS AS DEFINED IN 333 CMR 11.04. THERE SHALL BE NO APPLICATION WITHIN 10' OF STANDING WATER.

VEGETATION MANAGEMENT AREAS SHOWN INCLUDE ALL ANTICIPATED AREAS OF MOWING AND HERBICIDE APPLICATION. SELECTIVE TRIMMING MAY OCCUR ANYWHERE IN HOLYOKE, DEPENDING ON VEGETATION CONDITION AND PROXIMITY TO ELECTRICAL INFRASTRUCTURE, OR IN RESPONSE TO DAMAGE.

LEGEND:

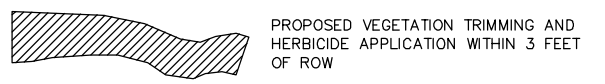

MAP REFERENCE:
 PLANIMETRIC DETAIL OBTAINED FROM ELECTRONIC SITE PLANS FOR THE REHABILITATION OF HADLEY FALLS RIVERSIDE PARK PREPARED BY FUSS & O'NEILL AND FERRERO-HIXON ASSOCIATES.

PROJ. MANAGER		CHIEF DESIGNER	
REVIEWED BY:	DATE		
1.	DATE	DESCRIPTION	BY
REVISIONS			

SCALE:	HORIZ: 1" = 1000'
	VERT: N/A
DATUM:	HORIZ:
	VERT:
GRAPHIC SCALE	

WWW.FandO.COM

FUSS & O'NEILL
Discipline to Deliver

78 INTERSTATE DR WEST SPRINGFIELD, MA 01089 413.452.0445

CITY OF HOLYOKE GAS & ELECTRIC DEPT.
 LOWER RIVERSIDE PARK
 VEGETATION MANAGEMENT PLAN 2008-2012
 HOLYOKE MASSACHUSETTS

PROJ. No.: 2000727.A55
 DATE: JANUARY 2008

LRP